



Safety and Security Solutions

Ph: 087 644 4497 Email: info@securitysafety.ie

www.securitysafety.ie

Fire Safety Training

Overview

Section 19 of the Safety, Health and Welfare at Work Act 2005 every employer shall identify hazards, assess risks and have a written risk assessment.

Section 20 record assessments in the Safety Statement. Emergency procedures must also be in place and practiced to ensure safe evacuation in the event of a fire.

Section 11 states that employers are required to prepare adequate emergency plans, procedures and provide the necessary measures for fire fighting and the evacuation of the workplace. **Section 10** Instruction, training and supervision of employees.

	Fire Extinguisher
ABC POWDER	
A	Safe for :- Wood, Paper, Textiles etc. ✓
B	Safe for :- Flammable liquids ✓
C	Safe for :- Gaseous fires ✓
	Safe for :- Live electrical equipment ✓
	Not for :- Flammable metal fires

Signs

Fire exit signs showing various directions: down, up, left, right, and diagonal. Includes a sign for 'In case of fire your assembly point is:' with a blank space for a sign.

ESCAPE PLAN



The safest way to deal with fire is to prevent it

Law



The keeping of fire safety records is an important element of the proper fire safety management of a premises.

Section 18: Fire Services Acts, 1981 and 2003 generally applies to all premises other than a dwelling house occupied as a single private dwelling. This section of the Act places a duty on persons having control over premises to –

- take all reasonable measures to guard against the outbreak of fire,
- provide reasonable fire safety measures,
- prepare and provide appropriate fire safety procedures,
- ensure that the fire safety measures and procedures are applied at all times,
- ensure as far as is reasonably practicable the safety of persons on the premises in the event of an outbreak of fire.

Guide

The Safety, Health and Welfare at Work (General Application) Regulations 2007 Chapter 1 of Part 2: Workplace

Regulation 11: Doors and Gates
May require a certain fire rating to maintain a secure means of escape in case of fire.

Mechanical doors and gates - can be opened manually where they operate as an emergency exit, unless they open automatically in the event of a power failure. Practice in opening such doors should form part of the programme for fire or emergency evacuation drills

Regulation 12: Emergency Routes and Exits
Emergency routes to emergency exits and the exits themselves are kept clear at all times and lead as directly as possible to the open air or to a safe area. Signs are placed at appropriate points

Regulation 13: Fire Detection and Fire Fighting
A place of work is equipped with appropriate fire-fighting equipment and, as necessary, fire detectors and an alarm system. Serviced by a competent person

Regulation 25: Employees with Disabilities
Employers should ensure that adequate assistance is provided for the safe evacuation of those with a disability in the event of an emergency



Safety and Security Solutions

Ph: 087 644 4497 Email: info@securitysafety.ie

www.securitysafety.ie

Fire Safety Training

Fire Extinguishers

To operate an extinguisher:

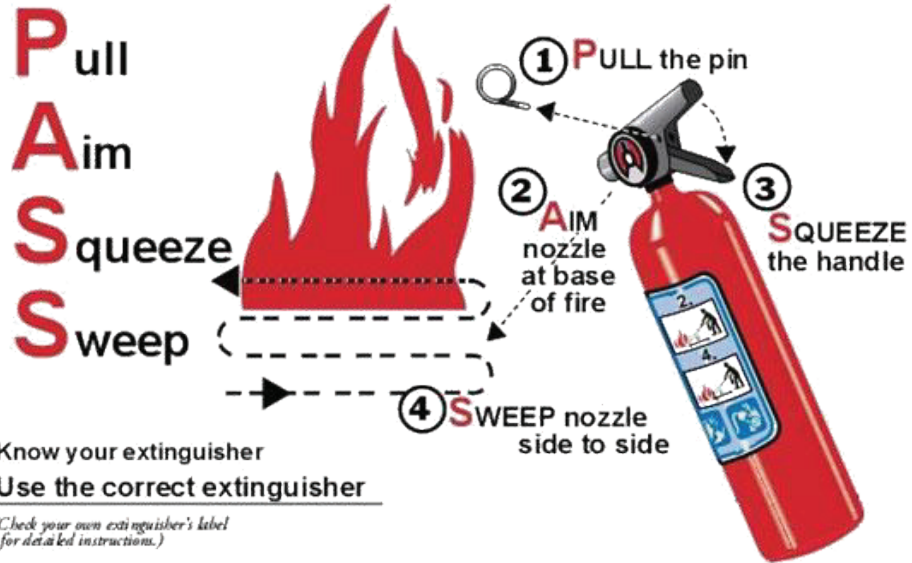

Types

Symbols found on fire extinguishers & what they mean

	Water	Foam spray	ABC powder	Carbon dioxide	Wet chemical
Wood, paper & textiles	✓	✓	✓	✗	✓
Flammable liquids	✗	✓	✓	✓	✗
Flammable gases	✗	✗	✓	✗	✗
Electrical contact	✗	✗	✓	✓	✗
Cooking oils & fats	✗	✗	✗	✗	✓